

Rulli formatori per tornitura lastra

Forming rolls for spinning



Rulli in Teflon®
Rolls made of Teflon®

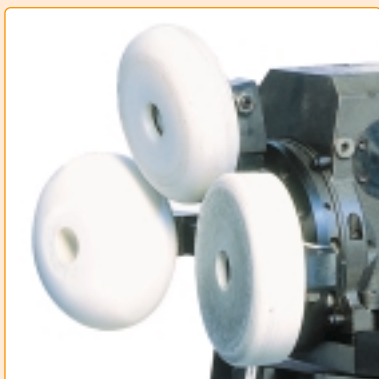
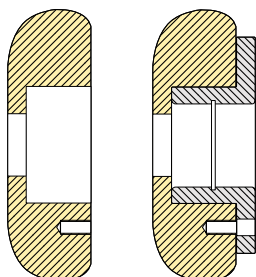

Fig.

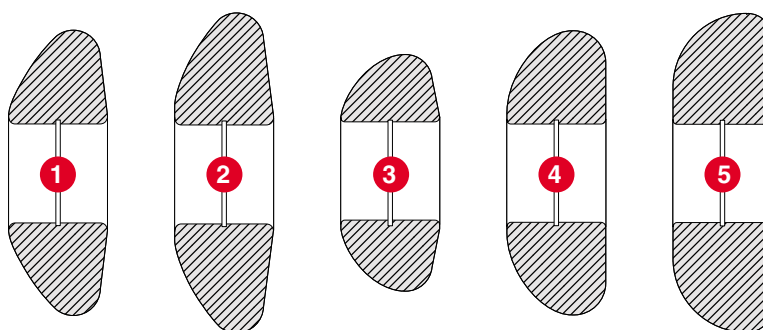

Fig.

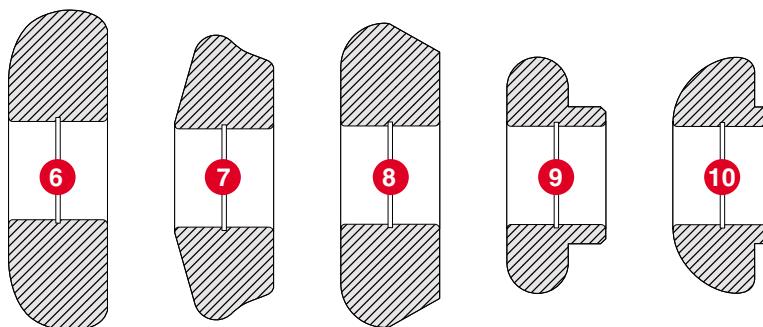

Fig.

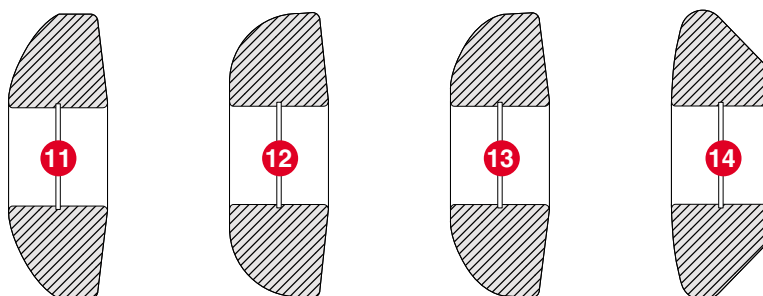

Fig.	ref.	diametro / diameter
1	51424	ø 118 mm
2	65684	ø 130 mm
3	61821	ø 96 mm
4	51595	ø 118 mm
5	55241	ø 130 mm
6	65275	ø 130 mm
7	54009	ø 118 mm

Fig.	ref.	diametro / diameter
8	52513	ø 124 mm
9	61817	ø 96 mm
10	61823	ø 96 mm
11	51492	ø 116 mm
12	51597	ø 116 mm
13	54001	ø 116 mm
14	54008	ø 118 mm

É possibile ordinare rulli con misure e forme differenti da quelle sopraindicate
It's possible to order rolls with other shapes or dimensions

Materiale rullo Roll material	Materiale lavorato Worked material				
	Acciaio Inox Stainless Steel	Fe	Al	Ottone Brass	Cu
Acciaio temprato / Hardened steel	<input checked="" type="checkbox"/>	<input checked="" type="checkbox"/>	<input checked="" type="checkbox"/>	<input checked="" type="checkbox"/>	<input checked="" type="checkbox"/>
Bronzo / Bronze	<input checked="" type="checkbox"/>	<input checked="" type="checkbox"/>			
Teflon®			<input checked="" type="checkbox"/>		
Resina sintetica / Synthetic resin			<input checked="" type="checkbox"/>	<input checked="" type="checkbox"/>	<input checked="" type="checkbox"/>

Rulli finitori per tornitura lastra

Finishing rolls for spinning

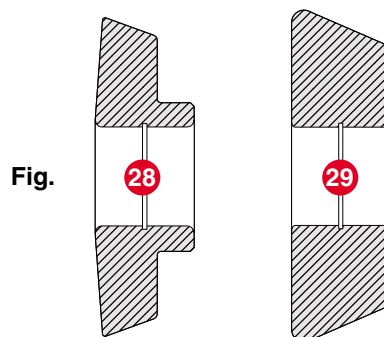
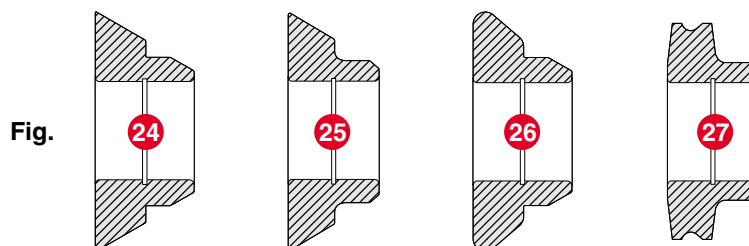
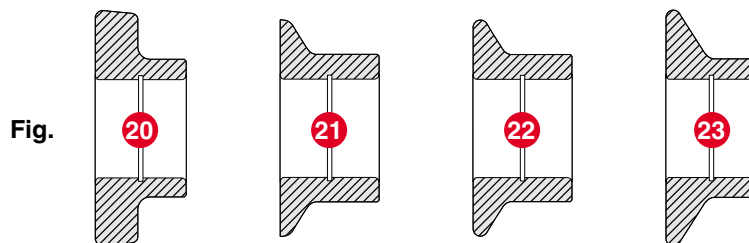

Rulli in Teflon®

Rolls made of Teflon®

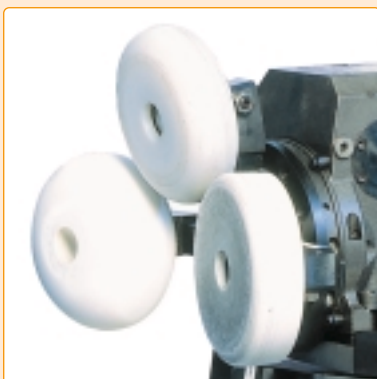
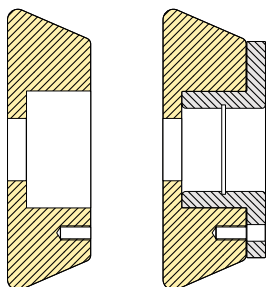

Fig.	ref.	diametro / diameter
20	61818	ø 98 mm
21	54004	ø 88 mm
22	60538	ø 88 mm
23	61819	ø 96 mm
24	52565	ø 98 mm

Fig.	ref.	diametro / diameter
25	61822	ø 96 mm
26	52514	ø 98 mm
27	61820	ø 88 mm
28	64884	ø 130 mm
29	65276	ø 130 mm

É possibile ordinare rulli con misure e forme differenti da quelle sopraindicate
It's possible to order rolls with other shapes or dimensions

Materiale rullo Roll material	Materiale lavorato Worked material				
	Acciaio Inox Stainless Steel	Fe	Al	Ottone Brass	Cu
Acciaio temprato / Hardened steel	<input checked="" type="checkbox"/>	<input checked="" type="checkbox"/>	<input checked="" type="checkbox"/>	<input checked="" type="checkbox"/>	<input checked="" type="checkbox"/>
Bronzo / Bronze	<input checked="" type="checkbox"/>	<input checked="" type="checkbox"/>			
Teflon®			<input checked="" type="checkbox"/>		
Resina sintetica / Synthetic resin			<input checked="" type="checkbox"/>	<input checked="" type="checkbox"/>	<input checked="" type="checkbox"/>