

## Incudini, tasselli, martello a spianare

Anvils, blocks, spring hammer

Enclumes, tas, marteau à planer



0497/1  
0497/2

### Tasso da ceppo in ghisa con piano rettificato

Cast iron flat anvil fine ground table  
Enclume en fonte, avec plan rectifié  
- 120 x 120 x 130 mm  
- 160 x 160 x 130 mm



0498

0498/A

0498

### Bicornia in acciaio forgiato su base in ghisa

Forged steel anvil with cast iron base  
Petite enclume en acier forgé avec base en fonte

0498A

### Incudinetta in acciaio forgiato senza base

Forged steel anvil without base  
Petite enclume en acier forgé sans base

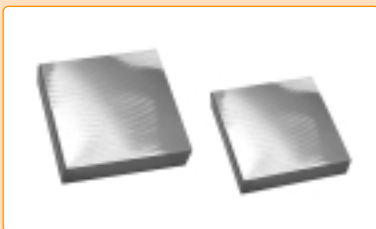

0496/1  
0496/2  
0496/3  
0496/4

### Tasselli piani in acciaio rettificato

Flat blocks in ground steel  
Tas carré en acier rectifié  
- 50 x 50 x 20 mm  
- 60 x 60 x 20 mm  
- 80 x 80 x 20 mm  
- 100 x 100 x 25 mm



0502

### Tassello piano (80 x 105 x 28 mm) con 8 cave mezzetonde

Flat block (80 x 105 x 28 mm) with 8 half-round slots  
Tas plat (80 x 105 x 28 mm) avec 8 rainures demi-rondes

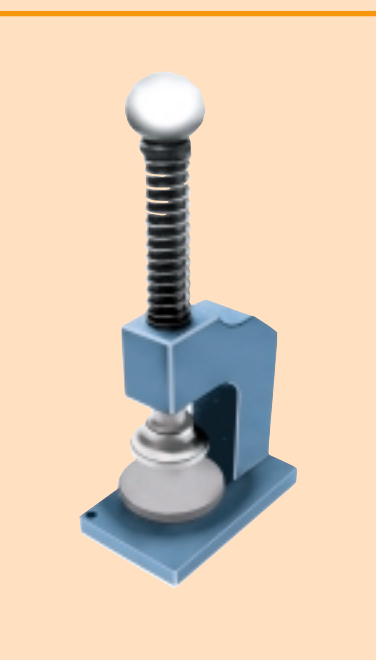

0495

### Martello a spianare; corpo in ghisa, battente e tassello in acciaio speciale trattato

Diametro della mazza e del tassello: 80 mm, altezza totale 500 mm, peso 20 kg  
Spring hammer; cast iron structure, hammer head and block (ø 80 mm) made of special treated steel. Total height 500 mm, weight 20 kg

Marteau à planer; corps en fonte aciéreuse, battant et cheville en acier spécial traité.  
Diamètre de la masse et de la cheville: 80 mm. Hauteur totale 500 mm, poids 20 kg

0495A

### Molla di ricambio

Spare spring / Ressort de rechange